

MISSION WEST PROPERTIES, Inc.

3544 Bassett Street, Santa Clara

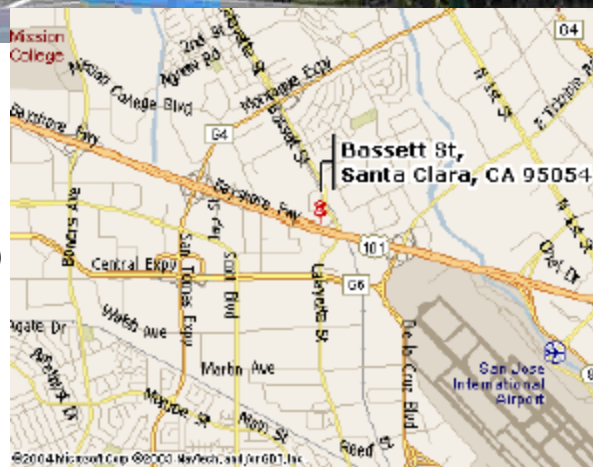

- Available Space: 23,310 sf (expandable to +/- 33,000sf)
- Parking 3.5/1000 rsf
- "NNN" \$0.115 psf / mo (Prop Taxes, Ins. & Landscaping)
- Santa Clara Utilities
- Shared Dock
- Available 5-1-12



For Further Information Please Contact:

Carl Berg
408-725-0700

berg@missionwest.com

Ray Marino
408-725-7632

rmarino@missionwest.com

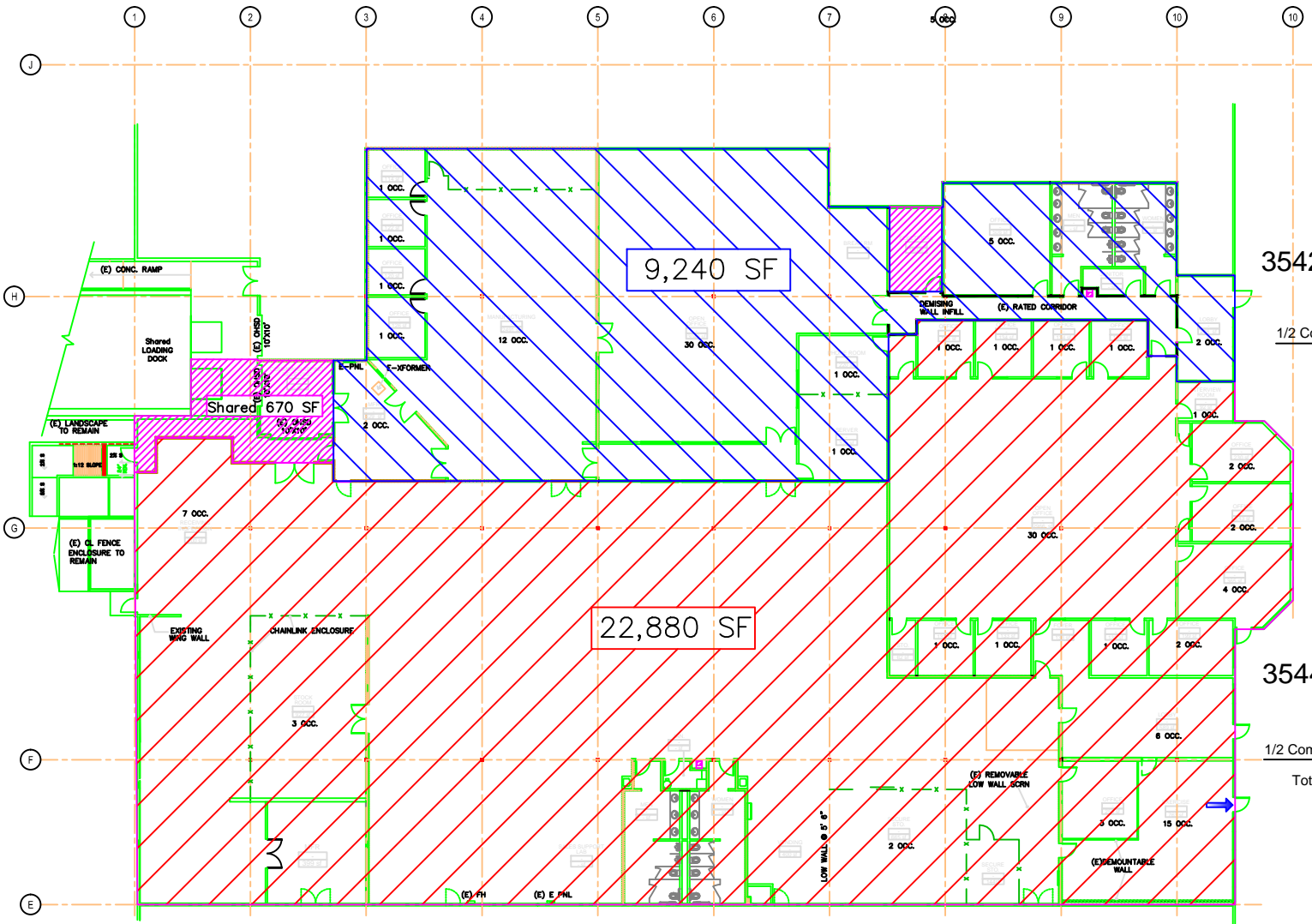

3542 Bassett St.
 9,240 sf
 1/2 Common 430 sf
 Total 9,670 sf

3544 Bassett St.
 22,880 sf
 1/2 Common 430 sf
 Total 23,310 sf