

# MISSION WEST PROPERTIES, INC.

**6850-B Santa Teresa Blvd, San Jose**



- Available Space: 17,262 sf
- Parking 3.5/1000 rsf
- Rent Negotiable; Available Now
- “NNN” \$0.134 psf / mo.  
(Prop Taxes, Ins. & Landscaping)
- 100% HVAC – Drop Ceiling
- Partially Furnished
- Call to Tour



**For Further Information Please Contact:**



**Carl Berg**  
**(408) 725-0700**

[berg@missionwest.com](mailto:berg@missionwest.com)

**Ray Marino**  
**(408) 725-7632**

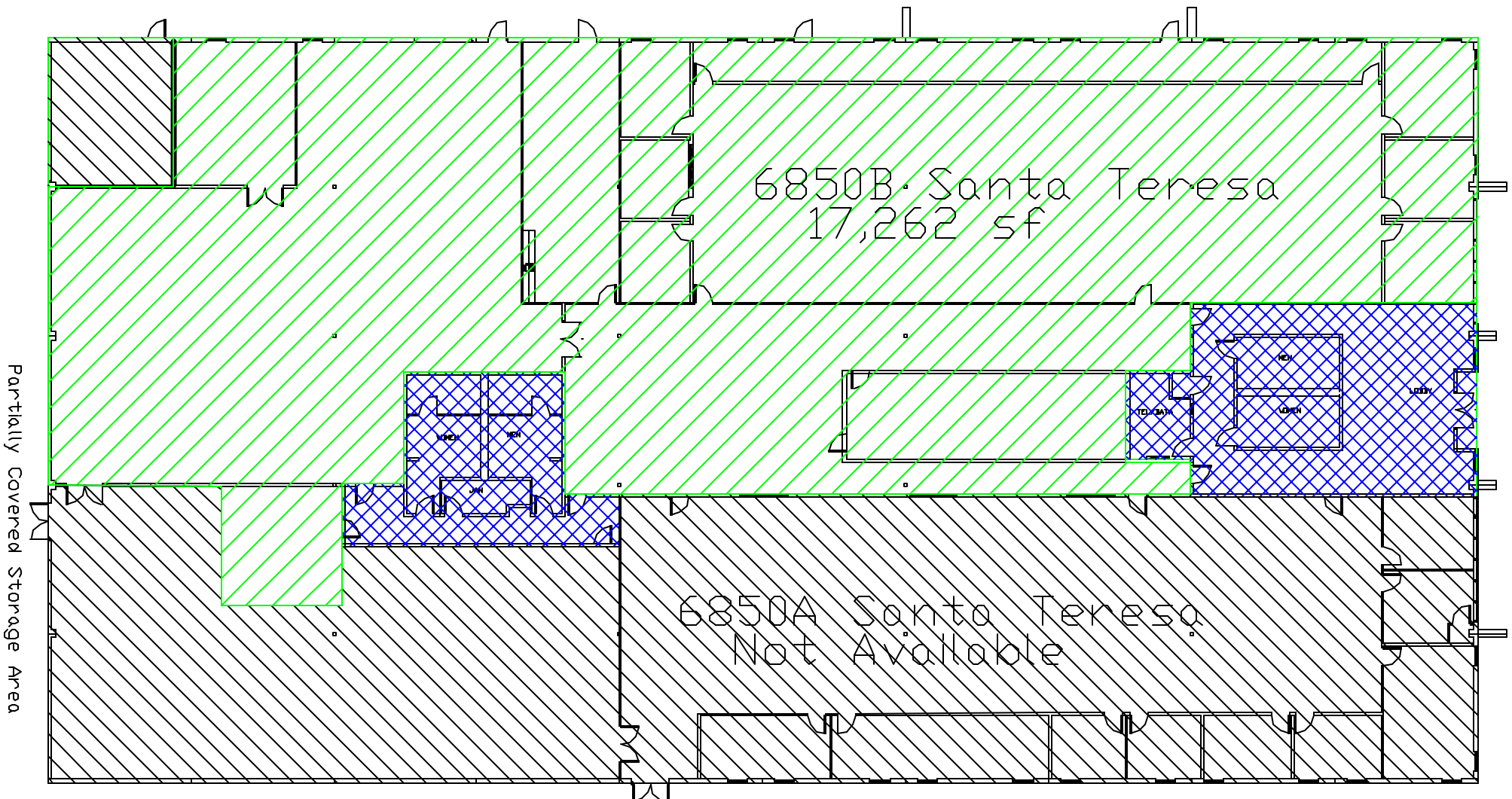
[rmarino@missionwest.com](mailto:rmarino@missionwest.com)



-  Suite A - Not Available
-  Common Areas

6850B Santa Teresa  
17,262 +/- Sq Ft